

**Albuquerque Office Complex
and
Santa Fe Headquarters Warehouse Project updates
Agenda item # 13**



Community Outreach

- On January 14, 2017, the Department held an “open house” on the property with approximately 20 local resident families attending.
 - Overall, the response from the local residents was positive with a few expressing concerns. These concerns included:
 - Increased traffic potential
 - OHV track (dust, noise) – no longer being considered by the Department.
- Each of the local residents in attendance was provided Department contact information. To date, three comments have been received.
 - Concerns included cost ,increased traffic, traffic calming measures and the OHV track.
 - Additional concerns on the traffic study data and the zoning
- Bernalillo County Public Works found that a formal traffic impact study was not required due to the minimal impact to the community.
- The Department conducted a traffic study to address the local resident concerns.
 - The trip generation for the proposed office when using the Standard Reference would be slightly lower than single family residential. However, the actual traffic counts show the office to be slightly higher.
 - The Department will work with Bernalillo County to further evaluate the need for traffic safety calming measures in the future.
- Additional public comment will be received via public meetings during a 30 day online comment period starting in mid-April as part of the Environmental Assessment (EA) process.
- The Department will hold another “open house” on the property April 8, 2017.

Albuquerque Design

- 70% Design has been completed with a target for 100% design in June
- The design firm, Bohannon Huston has been working directly with the Construction Industry Division (CID) and the following Bernalillo County agencies:
 - Traffic and Transportation
 - Water Utility Authority
 - County Hydrology Engineering
 - Pubic infrastructure plans have been submitted to the County and the Water Authority for input and comment.
 - County Planning Director meeting will be held at the 95% design.
- Construction is targeted to begin in September

Santa Fe Headquarters Warehouse



Warehouse Construction

- The Department started construction on a new warehouse at the Santa Fe headquarters' office in January 2017.
- The warehouse complex includes a 10,360 square foot warehouse and a 9,300 square foot covered storage.
- Construction completion is expected in June.
- This will replace the Department's current warehouse located on Richards Avenue in Santa Fe.

Santa Fe Headquarter's Warehouse Layout

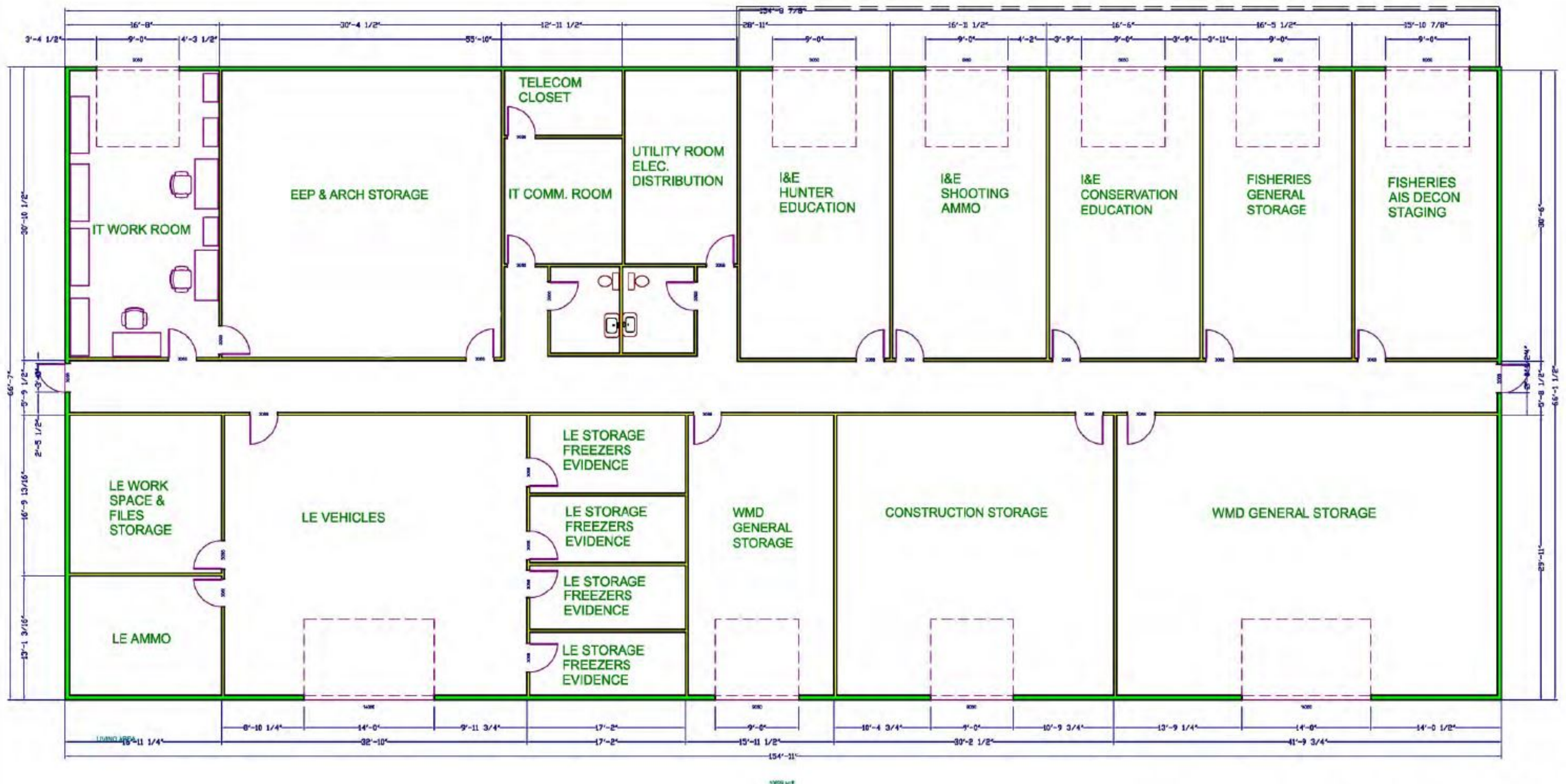

0 10 20 30 FEET



UNITED STATES DEPARTMENT OF THE INTERIOR	
U.S. FISH AND WILDLIFE SERVICE	
DIVISION OF ENGINEERING	
NEW MEXICO DEPARTMENT OF GAME & FISH	
SANTA FE NEW MEXICO	
HQ MAINTENANCE MASTERPLAN	
WAREHOUSE-STORAGE BUILDING	
SCHEMATIC FLOOR PLAN - REVISION 2	
DESIGN: BENJAMIN JOHNS	CHECK: GUSTIN
DRAWING FILENAME AND NUMBER	DATE: 1/12/15
DWGNO	SHT. NO. 1 OF 1

Questions?

