

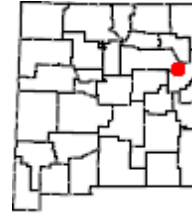

Oliver Farms, Tucumcari, OG.111



Access Type: Hunting, Walk-in Only Access.

Instructions: Before visiting this property, **attempt to call Oliver Farms at 575-708-0804** to notify the landowner of your plans.

Information: This property is located in GMU 42, a few miles north of Tucumcari, NM off Highway 104. Waste grain and crop residue from their operation help attract and feed game birds. There are two wells with overflow tanks on the property, which supply water for livestock and wildlife and provide some shooting opportunities for bird hunters. Rows of mature deciduous trees along fence lines and field borders provide roosting cover for birds on the property. **Walk-in Only Access. The northern boundary of this property has changed. See map on page 3.**

Permitted Uses: Hunting is only permitted on this property during the seasons and dates specified in the Open Gate lease agreement between the Department of Game and Fish and the landowner. Access to the property is subject to the terms and conditions in the Open Gate lease agreement and is restricted to the following permitted activities:

Permitted Activities	Available Dates	Remarks
Spring Turkey Hunting	April 15 – May 15, 2024  Please see the 2024-2025 Hunting Rules and Information.	Over-the-Counter Spring Turkey License Hunts Only. <u>Closed during the Youth-Only season</u> due to farming activities on the property.

***Please attempt to call Oliver Farms at 575-708-0804 and notify the landowner of your plans prior to using the property.**

Open Gate is a program that leases private lands to improve public access for hunting, fishing, and trapping. Open Gate leases are funded exclusively by hunters, anglers, and trappers through the purchase of the Habitat Management and Access Validation (HMAV).

Oliver Farms

Property Rules: The following rules will be posted on this property and enforced at the discretion of the Department of Game and Fish.

- Use of this Open Gate Property is restricted to properly licensed sportspersons for the following activities: **Spring Turkey Hunting (excluding youth turkey season)**
- No trespassing unless you are a properly licensed sportsperson, are accompanied by a properly licensed sportsperson or are license-exempt.
- Each properly licensed sportsperson or license-exempt person is allowed to be accompanied by no more than two guests.
- Scouting is only permitted during the two days immediately preceding the commencement of open season dates.
- No motor vehicle travel off designated roads or on closed roads.
- No destructive acts, including: vandalism, graffiti, theft, removal or defacing natural features, resources or signs.
- No target practice.
- No consumption of alcoholic beverages.
- No camping.
- No fires.
- No littering.
- **Access allowed from two hours before sunrise to two hours after sunset.**
- New Mexico Statute prohibits discharge of a firearm within 150 yards of a dwelling or building without permission of the structure's owner or lessee.
- No motor vehicle travel off designated roads or on closed roads. **This is a Walk-in Area – No motor vehicle travel allowed on this property.** Safely park alongside public roads and walk in.

The northern boundary of this property has changed and is identifiable by orange carsonite markers.

The area beyond the markers is closed.

NO HUNTING IS ALLOWED beyond the orange markers. This is a safety zone.



Rate this Property - NMDGF wants your feedback to ensure that this property is providing an enjoyable outdoor experience. Please take a moment to anonymously rate this property. We know your experience can differ each time you go afield, so be sure to provide a separate review each time you visit this Open Gate property. *After each visit you can quickly provide a review by clicking the **Rate a Property** tab on the [Open Gate homepage](#).*

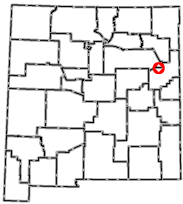

OPEN GATE
Hunting and Fishing
Access Program
Property OG.111

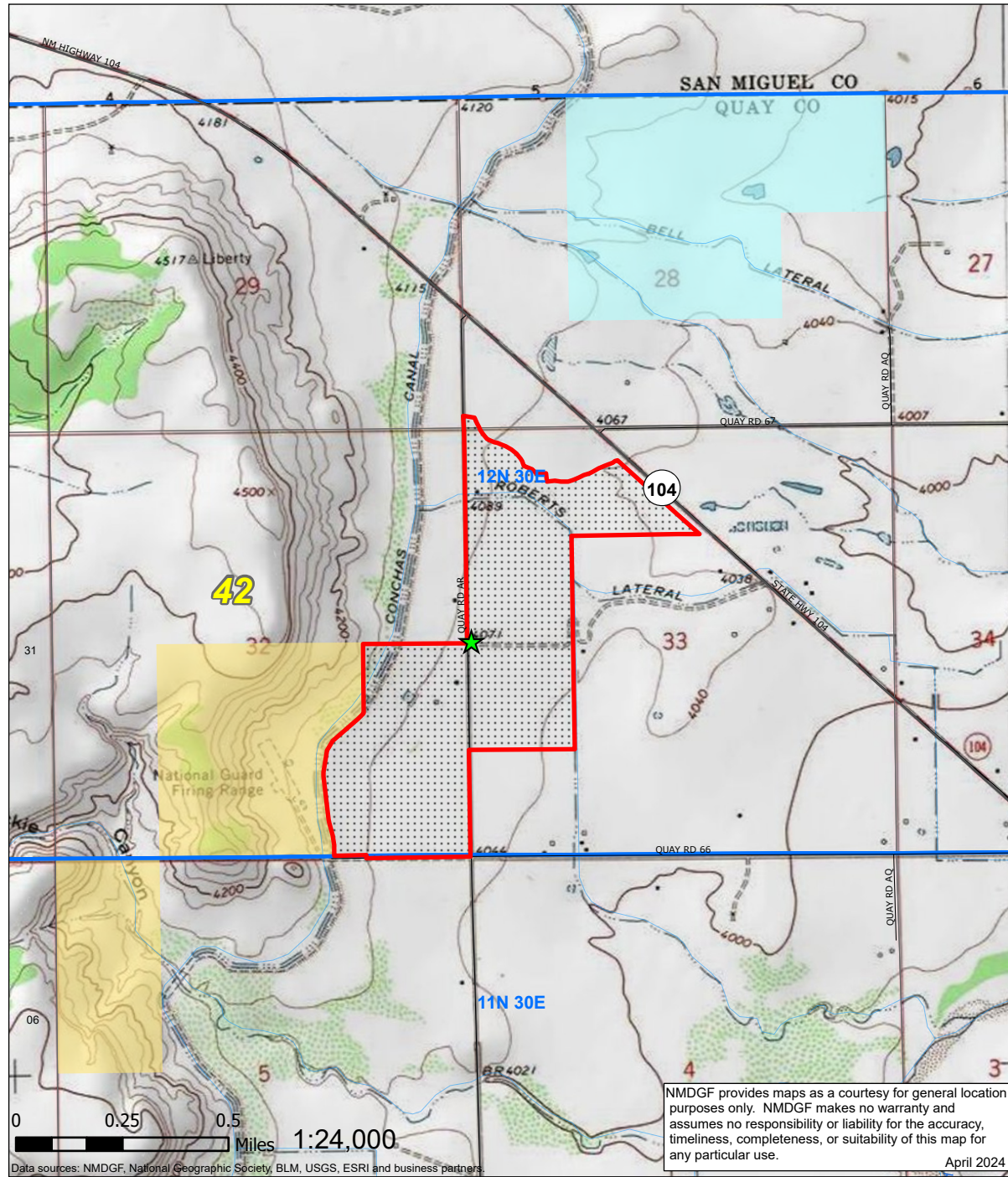
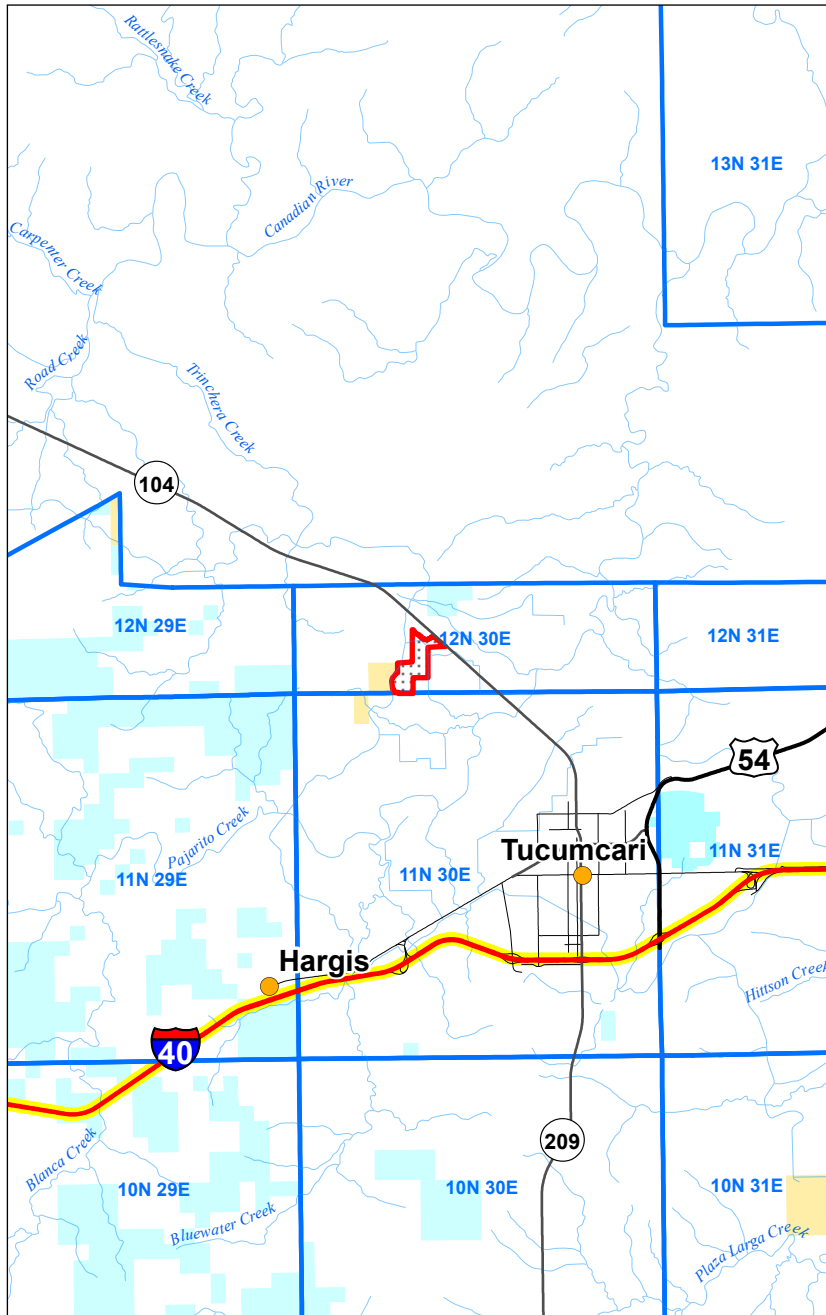

>>> Be Ethical, Courteous, and Safe <<<
All New Mexico Department of Game and Fish
regulations and seasons apply.

- Property Rules Sign
- Open Gate Property
- PLSS Township
- Game Management Unit
- Roads**
- Interstate Highway
- US Highway
- State Highway
- Secondary Road
- Surface Ownership**
- Bureau of Land Management
- Private
- State

